



OBERLIN FIRE DEPARTMENT

Application for Permit to Conduct Open Burning

Personal Information

Full Name:

Last

First

M.I.

Address:

Street Address

Apartment/Unit #

City

State

ZIP Code

Home Phone:

Alternate Phone: ()

Open Burning Site Information

Burn Site

Address:

Street Address

City or Township

County

- 1) Provide a sketch of the burn location below or on an attached sheet. Include the location of the site and burn location within the site, nearest road intersection(s) and distance to/placement of nearest off-site structures including a map showing distances to residences, populated areas, roadways, air fields, and other pertinent landmarks.

- 2) Describe the purpose for the burn.

Choose a category:

- Bonfire; not for waste disposal (max. 5' x 5' and 3 hour duration)
 Agricultural/residential waste ⁽¹⁾
 Land Clearing ⁽²⁾
 Recognized horticultural, silvicultural, range or wildlife management practices ⁽²⁾
 Fires and/or pyrotechnics as part of film-making or video production ⁽²⁾
 Prevention or control of disease or pests ⁽²⁾
 Disposal of ignitable or explosive materials ⁽²⁾
 Emergency burnings ⁽²⁾

⁽¹⁾ Requires notification to Ohio EPA; ⁽²⁾ Requires written approval from Ohio EPA

Provide a brief written description of your proposed burn:

- 3) Describe the material to be burned and the quantity of the material to be burned for any category identified in 2 above except for "Instruction for methods of fire fighting or for research in the control of fire" [see the following web link for what can be burned: <http://epa.ohio.gov/portals/27/regs/3745-19/3745-19-03.pdf>]



OBERLIN FIRE DEPARTMENT

Application for Permit to Conduct Open Burning

4) Did the material to be burned originate from the same site where it is being burned?
___Yes ___No

5) Is the burning site located within a restricted area? A restricted area is defined as the area within the boundaries of any municipal corporation (plus a 1,000 foot zone around cities having a population of 1,000 - 10,000 and a one (1) mile zone around cities greater than 10,000).
___Yes ___No

6) Provide the date(s) and Time(s) when the burning is anticipated to take place:

Begin		End	
Date	Time	Date	Time

Or,

For recognized horticultural, silvicultural, range management or wildlife management practices, please identify the range of dates and times the burn is expected to occur:

From: _____ **To:** _____

7) What methods or actions will be taken to reduce the emission of air contaminants?

Submission Certification

I, certify that the information set forth above is true and complete.

If authorized, said open burning will occur only during the approved hours and conducted in an area where an air pollution alert, warning, or emergency is in effect and that submission of this notification of intent does not exempt me from compliance with any other state or local regulation or ordinance. I also acknowledge that the Fire Department and/or Ohio EPA may determine that the open burning is not allowed under its regulations, or may impose certain requirements as part of approval of my request.

I hereby certify that materials will be dried and stacked (if appropriate) or otherwise prepared for burning in such a manner as to provide for the most complete combustion and least emission. I further certify that such burning will conform to the Ohio EPA and state fire code regulations, will not create a visibility hazard on roadways, railroad tracks or air fields, and will be performed at a point on the premises most remote from residential or populated areas in accordance with restrictions listed in this application and on the approved permit.

Signature

Date

FD USE ONLY: This application for permission to conduct open burning is hereby:

APPROVED – Permit # _____ DENIED

Signature of local fire official

Application for Permit to Conduct Open Burning Instructions

Personal Information

This information is used to issue a Permit indicating the approval or denial of the request. If Ohio EPA approval is necessary, please do not use a P.O. Box. The letter will be sent certified mail in order to ensure you receive a response from Ohio EPA. Phone number information allows us to contact you if we have additional questions concerning your request.

Open burning site information

- 1) A sketch of the site/location of the burn and nearby structures will allow us to determine if the burn will be conducted within the rule-based setback requirements. No burn is allowed within 1,000 feet of an off-site dwelling (e.g., your neighbor's house) in certain instances. Below is an example of an acceptable sketch.

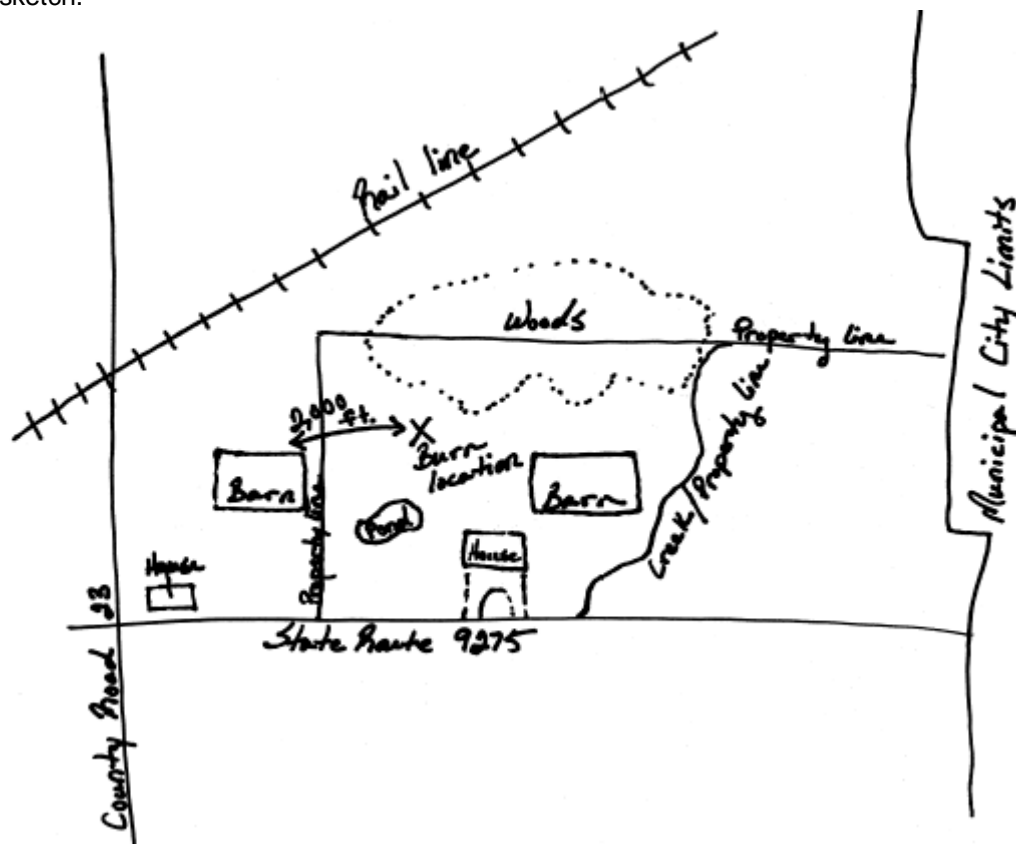

- 2) Please identify the category that best fits the reason you want to conduct a burn and describe the purpose for the burn. This information will assist us in determining if the requested burn is permissible under Ohio law. Please remember that if you are disposing of land clearing waste, you need to make sure the fire is set only when atmospheric conditions will readily dissipate the air contaminants; the fire does not create a visibility hazard on roadways, railroad tracks, or air fields; the fire is located at a point on the premises no less than one thousand feet from any inhabited building not located on the premises where the burn will occur; and an air curtain destructor or other device or method determined by the director to be at least as effective is used to curtail release of air contaminants.
- 3) Please describe the materials to be burned. This information is helpful in determining if the materials to be burned can be legally burned in Ohio. This is particularly important if there is a mixture of proposed materials. If there is a mixture, Ohio EPA can provide specific conditions in the approval letter allowing some materials to be burned while notifying you of which other materials cannot be burned. Inadequate description of the materials to be burned may result in denial of burning certain materials that may otherwise be legal.

Application for Permit to Conduct Open Burning Instructions

- 4) The material to be burned must originate from the site where it is to be burned. Material can be moved within a contiguous site to ensure distance setback requirements for off-site structures. However, moving materials from one site to another is not permitted by rule. Please provide sufficiently detailed information in 1 above if materials are moved within the proposed site.
- 5) Ohio open burning regulations are broken down into “restricted” and “unrestricted” areas. Different standards apply based on proximity to populated areas. Please identify if your proposed burn site meets the restricted versus unrestricted area designation.
- 6) Approved open burning must be attended to during the duration of the burn. As a result, some burns may extend beyond a single day. Please identify the dates/times the burn is proposed to cover. Please note that this is not the same as multiple burns over time. For example, an individual or organization may wish to conduct silvicultural burns in the fall and spring at the same or different locations. Such burns are separate actions and each individually requires a request and permission. The purpose of question 7 is to identify those burns that are intended to be continuous but cannot be due to personnel resources, expected weather conditions, etc.
- 7) Please describe any actions you will take to minimize emissions during the burn. For example, use of an air curtain destructor makes the burn more efficient (i.e., less polluting) and reduces the burn time.

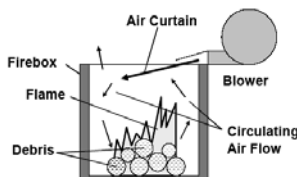

There are many configurations and equipment vendors that will rent the equipment. The basic concept is provided to the left. The overflow of introduced air facilitates efficient burning in the burn pile. Other activities that minimize emissions include making sure the materials are as dry as possible to ensure an efficient burn, allowing for sufficient air inflow by other means (e.g., burning the materials on raised structure so that air can flow upward into the burn more efficiently), etc.

Submission Certification

Sign and date the request. Note the signature criteria prior to signing the request. Ohio is substantially in attainment with the national ambient air quality standards. As a result, air pollution emergencies and warnings very are rare in Ohio. The following link provides the technical criteria for air pollution emergencies and warnings: <http://epa.ohio.gov/portals/27/regs/3745-25/3745-25-02.pdf> In addition, it is also important to check your local forecast for weather conditions prior to burning to make sure conditions are such that they will minimize air pollution impacts

Additional important information to note:

- The Ohio Department of Natural Resources has statutory authority for reviewing requests to conduct prescribed burns (e.g., burning off fields to promote prairie grasses). In addition, concerned with the potential for brush and forest fires, the ODNR Division of Forestry prohibits outdoor burning in rural areas between the hours of 6 a.m. and 6 p.m. during the typically dry months of March, April, May, October and November. So, regardless of if Ohio EPA grants permission to open burn from an environmental perspective, if you live in an unincorporated area, ODNR may deny permission to burn during these times/months due to fire safety concerns. For more information, see the following ODNR resources:
<http://www.dnr.state.oh.us/Portals/18/fire/pdf/OhioFireLaw.pdf>
<http://www.dnr.state.oh.us/forestry/Home/fire/wildfire/tabid/5146/Default.aspx>